

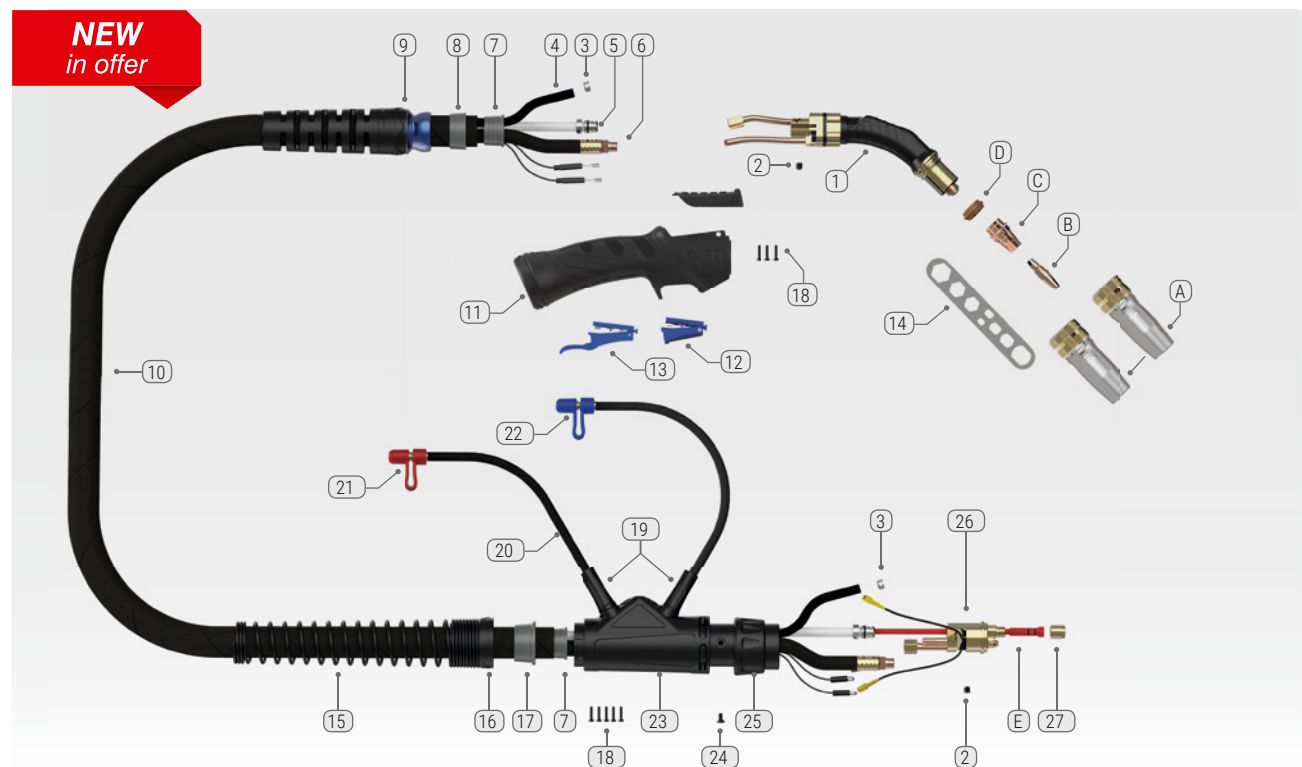

Scan the link or go to
<https://www.rywal.eu/f01-15>

M6W

Modern MIG/MAG welding torch for high-performance welding, especially using with pulse current



M60SW

Modern MIG/MAG welding torch for aluminium and CuSi wires

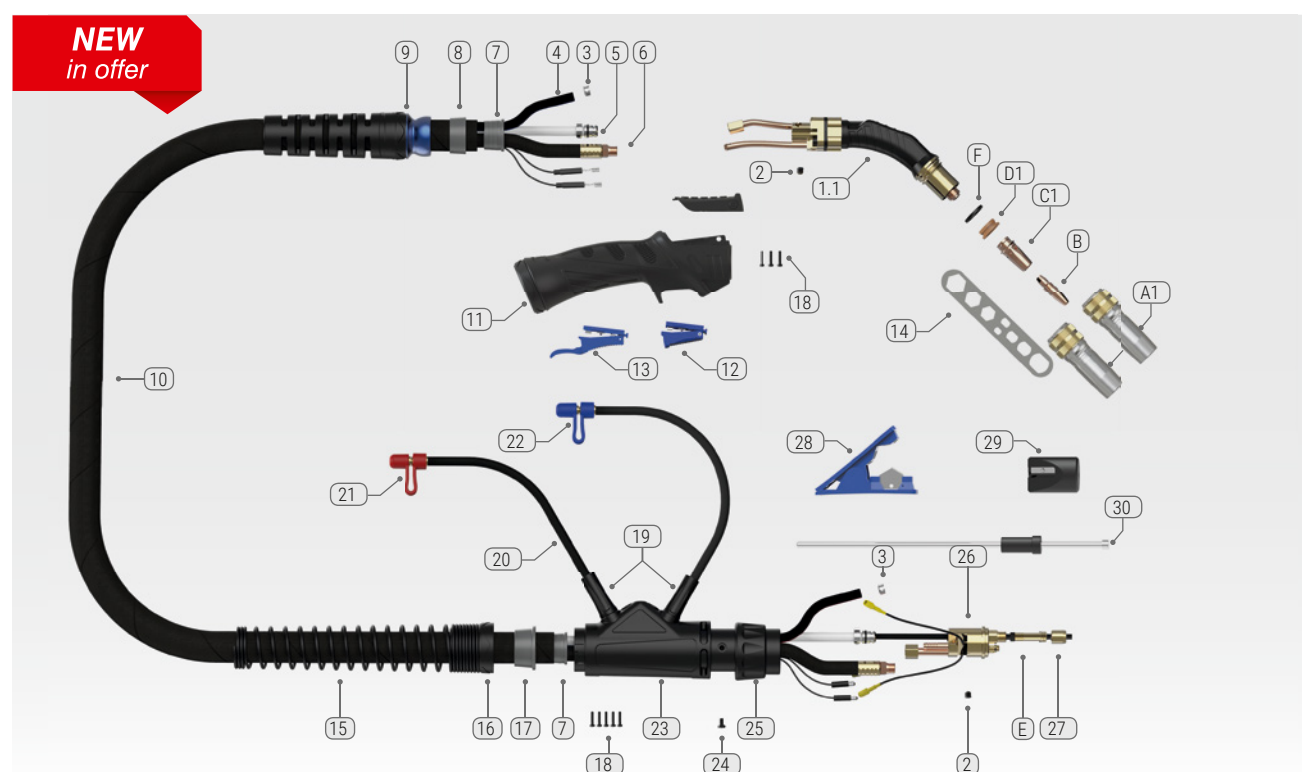

M6W / M6OSW

| Model | | M6W | | M6OSW | |
|-----------------------------|------------------|--|-------|--|-------|
| Cooling | | Liquid | | Liquid | |
| Rating | | Max. A | Pulse | Max. A | Pulse |
| CO ₂ | at 1.6 kW cooler | 580 A | 380 A | 580 A | 380 A |
| | at 1.2 kW cooler | 530 A | 350 A | 530 A | 350 A |
| MIX | at 1.6 kW cooler | 530 A | 380 A | 530 A | 380 A |
| | at 1.2 kW cooler | 480 A | 350 A | 480 A | 350 A |
| Min. coolant inlet pressure | | 3,0 bar | | 3,0 bar | |
| Minimum liquid flow | | 1,5 l/min | | 1,5 l/min | |
| Duty cycle | | 100% | | 100% | |
| Wire diameter | | 0,8-2,0 mm | | 0,8-2,0 mm | |
| Gas flow | | 8-20 l/min | | 8-20 l/min | |
| Length / Catalogue No. | | (3 m) 55 08 305113 (4 m) 55 08 305114 (5 m) 55 08 305115 | | (3 m) 55 08 305123 (4 m) 55 08 305124 | |

| No. | Replaceable elements | Catalogue No. |
|-----|----------------------------------|-----------------------|
| A | M6W conical gas nozzle Ø16* | 55 13 000740 |
| | M6W conical gas nozzle Ø14 | 55 13 000741 |
| A1 | M6OSW conical gas nozzle Ø15* | 55 13 000750 |
| | M6OSW conical gas nozzle Ø13 | 55 13 000751 |
| B | M10x35,5 contact tip | (see the table below) |
| C | M6W 28,5 mm* contact tip holder | 55 13 003984 |
| C1 | M6OSW 32,5 mm contact tip holder | 55 13 003987 |
| D | M6W insulator | 55 13 003980 |
| D1 | M6OSW insulator | 55 13 003981 |
| E | Liner | (see the table below) |
| F | O-ring | 55 13 003982 |
| 1 | M6W 45° swan neck | 55 13 014550 |
| 1.1 | M6OSW 45° swan neck | 55 13 014560 |
| 2 | M6x6 screw set | 55 13 006884 |
| 3 | GER 8,7 clamp | 50 15 000087 |
| 4 | Blue hose 5x1,5 | 51 13 007120 |
| 5 | Cable for M6W insert 3 m | 55 13 006403 |
| | Cable for M6W insert 4 m | 55 13 006404 |
| | Cable for M6W insert 5 m | 55 13 006405 |
| 6 | Power-water cable M6W 3 m | 55 13 006413 |
| | Power-water cable M6W 4 m | 55 13 006414 |
| | Power-water cable M6W 5 m | 55 13 006415 |
| 7 | Hoop | 55 13 006830 |
| 8 | Sheath block | 55 13 006848 |
| 9 | M6W torch stiffener | 55 13 006831 |

| No. | Replaceable elements | Catalogue No. |
|-----|--------------------------|---------------|
| 10 | M6W cable cover set 3 m | 55 13 006423 |
| | M6W cable cover set 4 m | 55 13 006424 |
| | M6W cable cover set 5 m | 55 13 006425 |
| | External cable cover (m) | 55 13 007201 |
| 11 | M6W handle | 55 13 006660 |
| 12 | M6W standard trigger | 55 13 006675 |
| 13 | M6W long trigger | 55 13 006676 |
| 14 | M6W key | 55 13 006685 |
| 15 | M6W euro plug spring | 55 13 006827 |
| 16 | Euro plug spring nut | 55 13 006680 |
| 17 | Euro plug inner ring | 55 13 006681 |
| 18 | Screw set | 55 13 006684 |
| 19 | Exit to a hose | 55 13 006686 |
| 20 | Red hose 5x1,5 | 51 13 007115 |
| 21 | Red hose plug | 55 13 006838 |
| 22 | Blue hose plug | 55 13 006840 |
| 23 | M6W euro plug housing | 55 13 006688 |
| 24 | M4x0,7 screw | 55 13 006683 |
| 25 | M6W euro plug nut | 55 13 006519 |
| 26 | Euro plug | 55 13 006687 |
| 27 | Special insert nut | 55 13 006695 |
| 28 | Insert cutter | 55 13 006690 |
| 29 | Cartridge sharpener | 55 13 006691 |
| 30 | Cartridge positioner | 55 13 006692 |

| M10x35,5 contact tip | | |
|-----------------------------|------------------|---------------|
| Wire diameter | | Catalogue No. |
| 0,8 mm M10x35,5 CuCrZr | | 55 13 003260 |
| 1,0 mm M10x35,5 CuCrZr | | 55 13 003262 |
| 1,2 mm M10x35,5 CuCrZr | | 55 13 003263 |
| 1,4 mm M10x35,5 CuCrZr | | 55 13 003264 |
| 1,6 mm M10x35,5 CuCrZr | | 55 13 003265 |
| 0,8 mm Al M10x35,5 CuCrZr | | 55 13 003270 |
| 1,0 mm Al M10x35,5 CuCrZr | | 55 13 003271 |
| 1,2 mm Al M10x35,5 CuCrZr | | 55 13 003272 |
| 1,6 mm Al M10x35,5 CuCrZr | | 55 13 003274 |
| Applicable to welding torch | ■ M6W ■ M6OSW | |

| Wire guides (Liners) | Catalogue No. |
|----------------------------------|---------------|
| Steel 1,0-1,2 red / 3 m | 55 13 012800 |
| Steel 1,0-1,2 red / 4 m | 55 13 012801 |
| Steel 1,0-1,2 red / 5 m | 55 13 012802 |
| Steel 1,6 yellow / 3 m | 55 13 012810 |
| Steel 1,6 yellow / 4 m | 55 13 012811 |
| Steel 1,6 yellow / 5 m | 55 13 012812 |
| Graphite 1,0-1,2 / 3 m | 55 13 012820 |
| Graphite 1,0-1,2 / 4 m | 55 13 012821 |
| Graphite 1,0-1,2 / 5 m | 55 13 012822 |
| For aluminium wire 1,0-1,2 / 3 m | 55 13 012823 |
| For aluminium wire 1,0-1,2 / 4 m | 55 13 012824 |
| For aluminium wire 1,6 / 3 m | 55 13 012825 |
| For aluminium wire 1,6 / 4 m | 55 13 012826 |